

# Universal Vacuum Cups

	Cup Size	Cup Material <sup>1</sup>	Cup Fitting	Filter
XP-U	8	S	-10M	
4	Ø 4 mm	N Nitrile	(Blank) None	(Blank) None
6	Ø 6 mm	S Silicone	See cup fittings for available threads.	-FD PE Filter Disc
8	Ø 8 mm	V Viton <sup>2</sup>		-FS SS Filter Screen
10	Ø 10 mm			See cup fittings for availability.
15	Ø 15 mm			

<sup>1</sup>All cups are available in Nitrile and Silicone. Check availability for other materials before ordering.

<sup>2</sup>Not available for XP-U15.

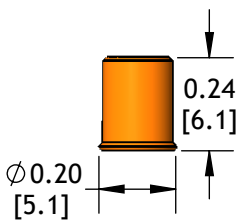

XP-U4

Cup Diameter: in [mm]	4 mm
Thru Hole: in [mm]	0.08 [2.0]
Stroke: in [mm]	0.008 [0.2]
Cup Weight: oz [g]	0.003 [0.09]
Internal Volume: cu in [cc]	0.002 [0.03]
Force @ 6 inHG: lb [n]	0.04 [0.2]
Force @ 18 inHG: lb [n]	0.20 [0.9]
Minimum Radius: in [mm]	0.12 [3.0]

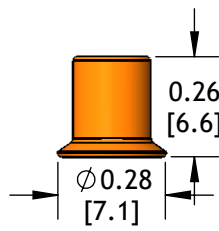

XP-U6

Cup Diameter: in [mm]	6 mm
Thru Hole: in [mm]	0.08 [2.0]
Stroke: in [mm]	0.012 [0.3]
Cup Weight: oz [g]	0.005 [0.14]
Internal Volume: cu in [cc]	0.003 [0.5]
Force @ 6 inHG: lb [n]	0.11 [0.5]
Force @ 18 inHG: lb [n]	0.38 [1.7]
Minimum Radius: in [mm]	0.20 [5.1]

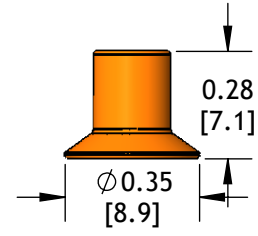

XP-U8

Cup Diameter: in [mm]	8 mm
Thru Hole: in [mm]	0.8 [2.0]
Stroke: in [mm]	0.02 [0.5]
Cup Weight: oz [g]	0.005 [0.14]
Internal Volume: cu in [cc]	0.006 [0.1]
Force @ 6 inHG: lb [n]	0.22 [1.0]
Force @ 18 inHG: lb [n]	0.65 [2.9]
Minimum Radius: in [mm]	0.24 [6.1]

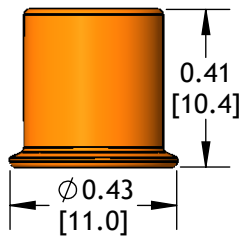

XP-U10

Cup Diameter: in [mm]	10 mm
Thru Hole: in [mm]	0.14 [3.6]
Stroke: in [mm]	0.02 [0.5]
Cup Weight: oz [g]	0.03 [0.9]
Internal Volume: cu in [cc]	0.01 [0.2]
Force @ 6 inHG: lb [n]	0.34 [0.5]
Force @ 18 inHG: lb [n]	1.00 [4.5]
Minimum Radius: in [mm]	0.31 [7.9]

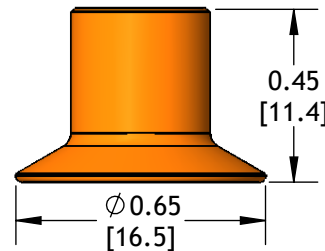

XP-U15

Cup Diameter: in [mm]	15 mm
Thru Hole: in [mm]	0.14 [3.6]
Stroke: in [mm]	0.06 [1.5]
Cup Weight: oz [g]	0.03 [0.9]
Internal Volume: cu in [cc]	0.03 [0.5]
Force @ 6 inHG: lb [n]	0.80 [3.6]
Force @ 18 inHG: lb [n]	1.90 [8.5]
Minimum Radius: in [mm]	0.31 [7.9]

## Universal Vacuum Cups

	Cup Size	Cup Material <sup>1</sup>	Cup Fitting	Filter
XP-U	25	N	-14M	-FS
20	Ø 20 mm	N	(Blank) None	(Blank) None
25	Ø 25 mm	S	See cup fittings for available threads.	-FD PE Filter Disc
30	Ø 30 mm			-FS SS Filter Screen
40	Ø 40 mm			See cup fittings for availability.
50	Ø 50 mm			

<sup>1</sup>All cups are available in Nitrile and Silicone. Check availability for other materials before ordering.

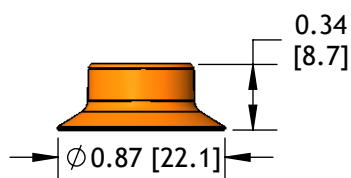

**XP-U20**

Cup Diameter: in [mm]	20 mm
Thru Hole: in [mm]	0.20 [5.1]
Stroke: in [mm]	0.10 [2.5]
Cup Weight: oz [g]	0.04 [1.1]
Internal Volume: cu in [cc]	0.06 [1.0]
Force @ 6 inHG: lb [n]	1.30 [5.8]
Force @ 18 inHG: lb [n]	2.70 [12.0]
Minimum Radius: in [mm]	0.51 [13.0]

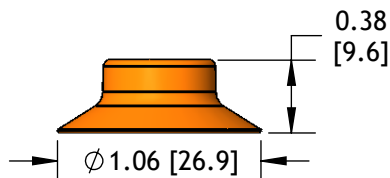

**XP-U25**

Cup Diameter: in [mm]	25 mm
Thru Hole: in [mm]	0.20 [5.1]
Stroke: in [mm]	0.10 [2.5]
Cup Weight: oz [g]	0.06 [1.7]
Internal Volume: cu in [cc]	0.07 [1.1]
Force @ 6 inHG: lb [n]	2.00 [8.9]
Force @ 18 inHG: lb [n]	4.40 [19.6]
Minimum Radius: in [mm]	0.65 [16.5]

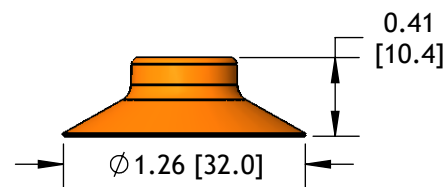

**XP-U30**

Cup Diameter: in [mm]	30 mm
Thru Hole: in [mm]	0.20 [5.1]
Stroke: in [mm]	0.14 [3.6]
Cup Weight: oz [g]	0.07 [2.0]
Internal Volume: cu in [cc]	0.12 [2.0]
Force @ 6 inHG: lb [n]	2.70 [12.0]
Force @ 18 inHG: lb [n]	5.60 [24.9]
Minimum Radius: in [mm]	0.79 [20.1]

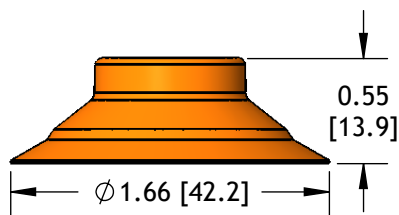

**XP-U40**

Cup Diameter: in [mm]	40 mm
Thru Hole: in [mm]	0.29 [7.4]
Stroke: in [mm]	0.18 [4.6]
Cup Weight: oz [g]	0.17 [4.8]
Internal Volume: cu in [cc]	0.34 [5.6]
Force @ 6 inHG: lb [n]	4.50 [20.0]
Force @ 18 inHG: lb [n]	8.80 [39.1]
Minimum Radius: in [mm]	1.18 [30.0]

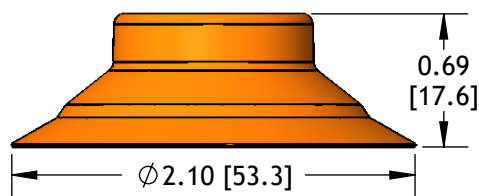

**XP-U50**

Cup Diameter: in [mm]	50 mm
Thru Hole: in [mm]	0.36 [9.1]
Stroke: in [mm]	0.24 [6.1]
Cup Weight: oz [g]	0.35 [9.9]
Internal Volume: cu in [cc]	0.73 [12.0]
Force @ 6 inHG: lb [n]	7.90 [35.1]
Force @ 18 inHG: lb [n]	16.40 [73.0]
Minimum Radius: in [mm]	1.38 [35.1]