

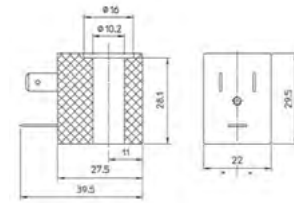

5 WATT COILS - 22mm x Ø10mm
LBA - Molding material: PA - Black Polyamide
Class F (155°C)

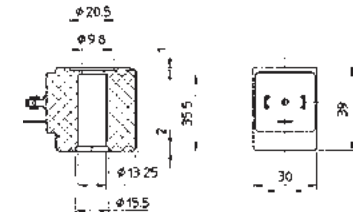

8 WATT COILS - 30mm x Ø13mm
BDA - Molding material: PA - Black Polyamide
Class F (155°C)



12 WATT COILS - 36mm x Ø13mm
UDA - Molding material: EP - Black Epoxy Resin
Class F (155°C)

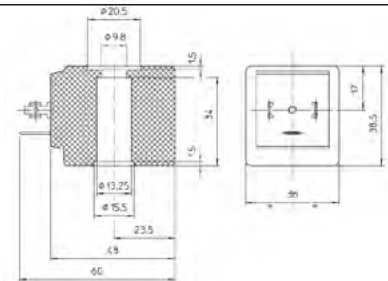

14 WATT COILS - 52mm x Ø13mm
GDH - Molding material: EP - Black Epoxy Resin
Class H (180°C)

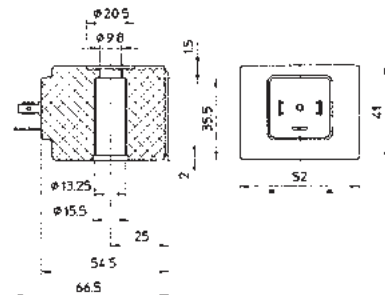

CODE	POWER	VOLTAGE	DESCRIPTION	APPROVALS
5W12D	5 WATT	12 VDC	COMPACT	CE
5W24D	5 WATT	24 VDC	COMPACT	CE
5W24A	5 WATT	24 V 50Hz	COMPACT	CE
5W110A	5 WATT	110 V 50Hz	COMPACT	CE UL
5W230A	5 WATT	230 V 50Hz	COMPACT	CE
12D	8 WATT	12 VDC	STANDARD	
24D	8 WATT	24 VDC	STANDARD	CE
24A	8 WATT	24 VDC	STANDARD	CE
110A	8 WATT	110 V 50Hz	STANDARD	CE
240A	8 WATT	240 V 50Hz	STANDARD	CE
400A	8 WATT	400 V 50Hz	STANDARD	
14W12D	14 WATT	12 VDC	HI PERFORMANCE	
14W24D	14 WATT	24 VDC	HI PERFORMANCE	CE
14W24A	14 WATT	24 V 50Hz	HI PERFORMANCE	CE
14W110A	14 WATT	110 V 50Hz	HI PERFORMANCE	CE
14W220A	14 WATT	220 V 50Hz	HI PERFORMANCE	CE

mpmDIN Square DIN Plug for 8 and 14 WATT Coils



mPmREC Rectangular Plug for 5 WATT Coils



Nominal Voltage DC +10% -5%
 Tolerances: AC +10% -15%

Other voltages and power absorptions available on demand and for quantities.