



Repairable Hole Punch Cylinders



Our rugged hole punch cylinder has been redesigned with a removable cutter to allow customers to replace the cutter as needed without having to replace the entire cylinder. The razor sharp cutting teeth are designed to punch millions of holes in thin plastic film.

- High strength carbon steel rod is hollow with an ID of .07" to provide an air jet to eject cutter slugs from the cutting head.
- An oil soaked felt washer beside the rod seal provides a continuous source of lubrication to the rod on every stroke.
- (8) models with (7) different cutter diameters for a wide range of applications.
- Available with no cutter for customers that choose to mount their own.
- Single acting, spring return 3/4" bore, 1" stroke cylinder is prelubricated for maximum life.
- Nickel plated steel rod guide offers improved fatigue resistance over competitors aluminum end caps which is critical in high speed/high cycle applications.
- Bumpers are present for both extend and retract strokes to minimize sound levels.
- Special cutter shapes and different stroke lengths are available on request.

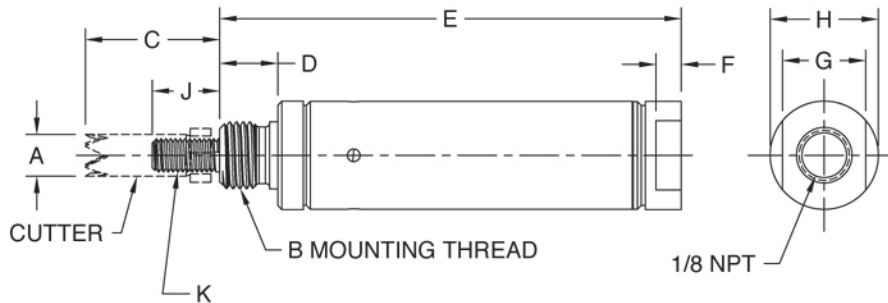

Model No.	Hole Size	A	B	C	D	E	F	G	H	J	K	Price
D-11840-A Base Weight: .18	1/4"	.250"	1/2-20	.50	.44	3.44	.19	.62	.81	.25	#10-32 ²	\$41.15
D-9846-A¹ Base Weight: .19	N/A	N/A	1/2-20	.50	.44	3.44	.19	.62	.81	.50	1/4-28	39.20
D-11811-A Base Weight: .20	5/16"	.312"	1/2-20	1.00	.44	3.44	.19	.62	.81	.50	1/4-28 ²	51.50
D-11618-A Base Weight: .21	3/8"	.375"	1/2-20	1.00	.44	3.44	.19	.62	.81	.50	1/4-28 ²	51.50
D-11998-A Base Weight: .23	7/16"	.438"	5/8-18	1.00	.50	3.50	.19	.62	.81	.50	3/8-40 ³	59.15
D-11999-A Base Weight: .24	1/2"	.500"	5/8-18	1.00	.50	3.50	.19	.62	.81	.50	3/8-40 ³	59.15
D-12107-A Base Weight: .29	9/16"	.562"	3/4-16	1.00	.63	3.63	.19	.62	.99	.50	3/8-40 ³	64.10
D-12108-A Base Weight: .29	5/8"	.625"	3/4-16	1.00	.63	3.63	.19	.62	.99	.50	3/8-40 ³	64.10

¹The Pneumatic Hole Puncher Cylinder may be ordered without the cutter under model number D-9846-A. This cylinder has the same features and dimensions as the Hole Puncher except 1/4-28 UNF-2A by 0.50 long rod threads are provided so you may attach your own cutter.

²Cutter to rod mating threads

³Cutter to rod end adapter mating threads

Repairable Hole Punch Cylinders

Engineering Specifications

Maximum Pressure: 250 psi (air)
Temperature Range: -20° F to 200° F
Body: 304 Stainless Steel
Rod: Ground and Polished Carbon Steel
Front End Cap: Nickel Plated Steel
Rear End Cap: Aluminum
Lubrication: Permanent Grease Lubrication for Piston Seals
Oil Soaked Felt Washer for Rod Seal





Repair Kits

Each box of (5) cutters includes (5) O-rings and repair instructions



Model No.	Price
Repunch - 1/4	\$79.05
Repunch - 5/16	88.10
Repunch - 3/8	91.45
Repunch - 7/16	130.50
Repunch - 1/2	140.90
Repunch - 9/16	142.75
Repunch - 5/8	146.25

Cutter Styles and Sizes

1/4" diameter	
5/16" diameter	
3/8" diameter	
7/16" diameter	

1/2" diameter	
9/16" diameter	
5/8" diameter	