

## Liquifit Tube to tube fittings

### How to build Part Numbers

6305 56 11GP2 = quantity of order 10 pcs  
 6305 56 11GP3 = quantity of order 100 pcs  
 6305 56 11GP4 = quantity of order 1000 pcs



### How to determine color codes



### 6316 Bulkhead union

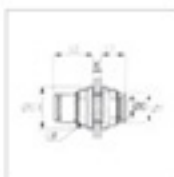

D		P2	P3	P4	F	Kmax	L1	L2	Tmin	oz
1/4	6316 56 00WP2	10	100	1000	16	0.35	0.37	0.93	0.53	.160
3/8	6316 60 00WP2	10	100	1000	22	0.57	0.51	0.93	0.73	.476
1/2	6316 62 00WP2	5	50	500	29	0.81	0.67	0.93	1.00	1.19
1/4	6316 56 00GP2	10	100	1000	16	0.35	0.37	0.93	0.53	.160
3/8	6316 60 00GP2	10	100	1000	22	0.57	0.51	0.93	0.73	.476
1/2	6316 62 00GP2	5	50	500	29	0.81	0.67	0.93	1.00	1.19

### 6340 Two-way divider

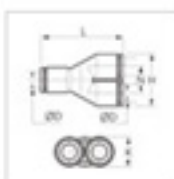

D		P2	P3	P4	H	K	L	N	oz
1/4	6340 56 00WP2	10	100	1000	0.87	0.43	1.42	0.45	.122
3/8	6340 60 00WP2	10	100	1000	1.30	0.63	2.09	0.67	.374
1/2	6340 62 00WP2	5	50	500	1.77	0.87	2.64	0.90	1.01
1/4	6340 56 00GP2	10	100	1000	0.87	0.43	1.42	0.45	.122
3/8	6340 60 00GP2	10	100	1000	1.30	0.63	2.09	0.67	.374
1/2	6340 62 00GP2	5	50	500	1.77	0.87	2.64	0.90	1.01

### 6351 End stop



D		P2	P3	P4	G	H	oz
1/4	6351 56 00WP2	10	100	1000	0.41	0.64	.044
3/8	6351 60 00WP2	10	100	1000	0.53	0.88	.113
1/4	6351 56 00GP2	10	100	1000	0.41	0.64	.044
3/8	6351 60 00GP2	10	100	1000	0.53	0.88	.113